

## SureX A4 Series Gear Pump

SureX A4 series gear pumps are designed for foam extinguishing systems, for pressure stabilization or foam transfer, with strong self-priming capability, suitable for foam and water of various viscosities, and can be driven by electric motor, gasoline engine or water turbine.

### Technical Data:

Max Pressure: 2.0MPa | 20 bar

Max Speed: 1800 RPM

Viscosity: 6000cp max

Connection Diameter: 1/2" or 3/4"

Connection Type: Inner thread

Certificate: —

[1] Brookfield viscometer, spindle #4, speed 30rpm.

### Materials:

Pump body taper bush: Reb brass ASTM B584 C83600

Rotor: Stainless steel 17-4PH Bronze ASTM B103 C53200

Front Cover/Back Cover: Red Brass ASTM B584 C83600

Lip Seal: FPM

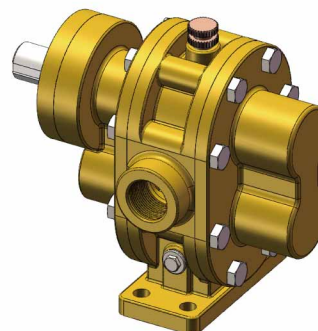

### A4.1 Performance-Water

Foam Pump	1500rpm			1800rpm		
	Pressure bar	Flow L/min	Power kw	Torque N.m	Flow L/min	Power kw
	5.0	24	0.7	4.6	30	0.9
	6.9	23	0.9	6.0	29	1.1
	10.3	22	1.2	7.3	27.5	1.4
	13.8	21	1.5	9.4	26	1.8
	17.2	20	1.7	10.9	25	2.1
	20	19	2.1	13.1	24	2.5

### A4.2 Performance-Water

Foam Pump	1500rpm			1800rpm		
	Pressure bar	Flow L/min	Power kw	Torque N.m	Flow L/min	Power kw
	5.0	51	1.3	8.3	61	1.5
	6.9	49	1.7	10.8	60	2
	10.3	45	2	12.7	56	2.4
	13.8	42	2.5	15.9	52	3
	17.2	40	2.9	18.5	50	3.5
	20.0	38	3.5	22.3	49	4.3

\* Performance parameters are subject to the final actual test

### Dimensions

